

# EXECUTIVE DECISION RECORD SHEET

<b>Name of decision maker:</b>	<b>Councillor Andrew Williams</b>
<b>Portfolio:</b>	<b>Commercial Strategy &amp; Delivery</b>
<b>Date of Portfolio Holder Decision:</b>	

**Title of Decision:**

To undertake consultations on the proposal to introduce waiting restrictions on Anchor Lane, Hemel Hempstead and on Beechfield Road, Hemel Hempstead and to delegate the decision to introduce the restrictions, if applicable, to the Head of Commercial Development in consultation with the Portfolio Holder for Commercial Strategy & Delivery.

**Decision made and reasons:**

To engage consultants (ADL Highways and Traffic Engineering) to undertake consultations on the proposal to:

1. To revoke the No Waiting 'Mon-Fri 8.30am to 4.30pm' (Single Yellow Line) restriction on Anchor Lane near to the junction with Heath Lane, and replace with the introduction of No Waiting at Any Time (Double Yellow Lines) restrictions, please see the map below:

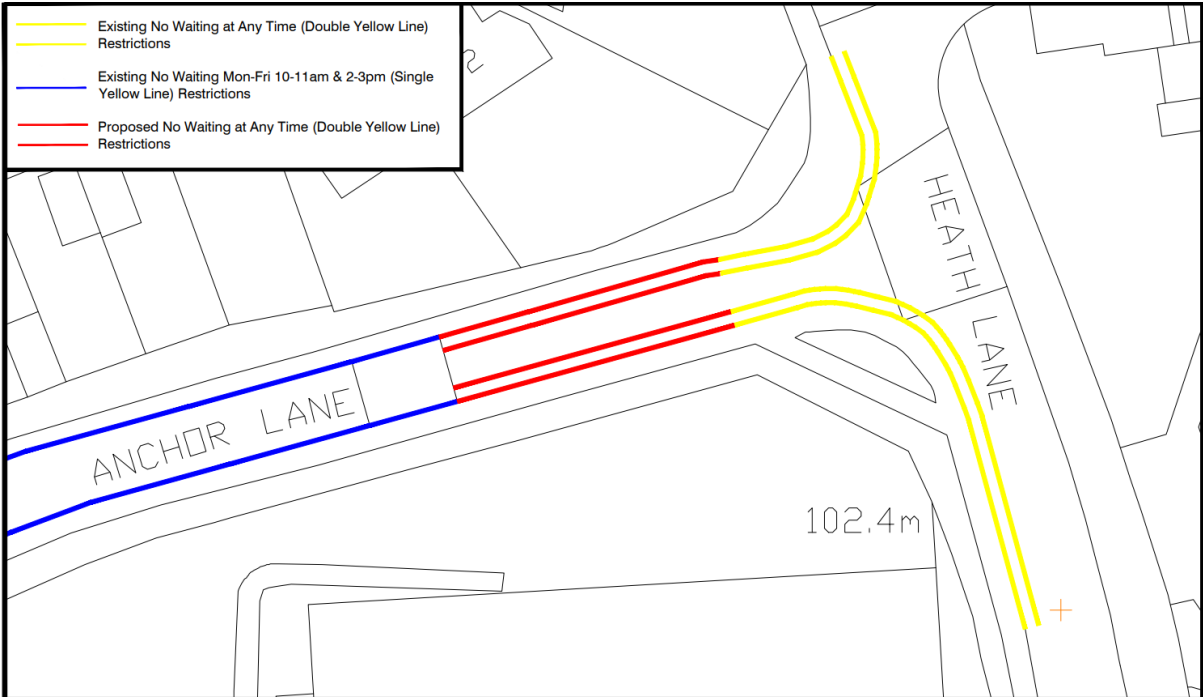

2. To introduce additional no waiting at any time (Double Yellow Lines) at the junction of Beechfield Road and Anchor Lane the request is to prevent parking close to or on the mini roundabout and to prevent inappropriate verge parking on Beechfield Road, please see the map below:

EXECUTIVE DECISION RECORD SHEET

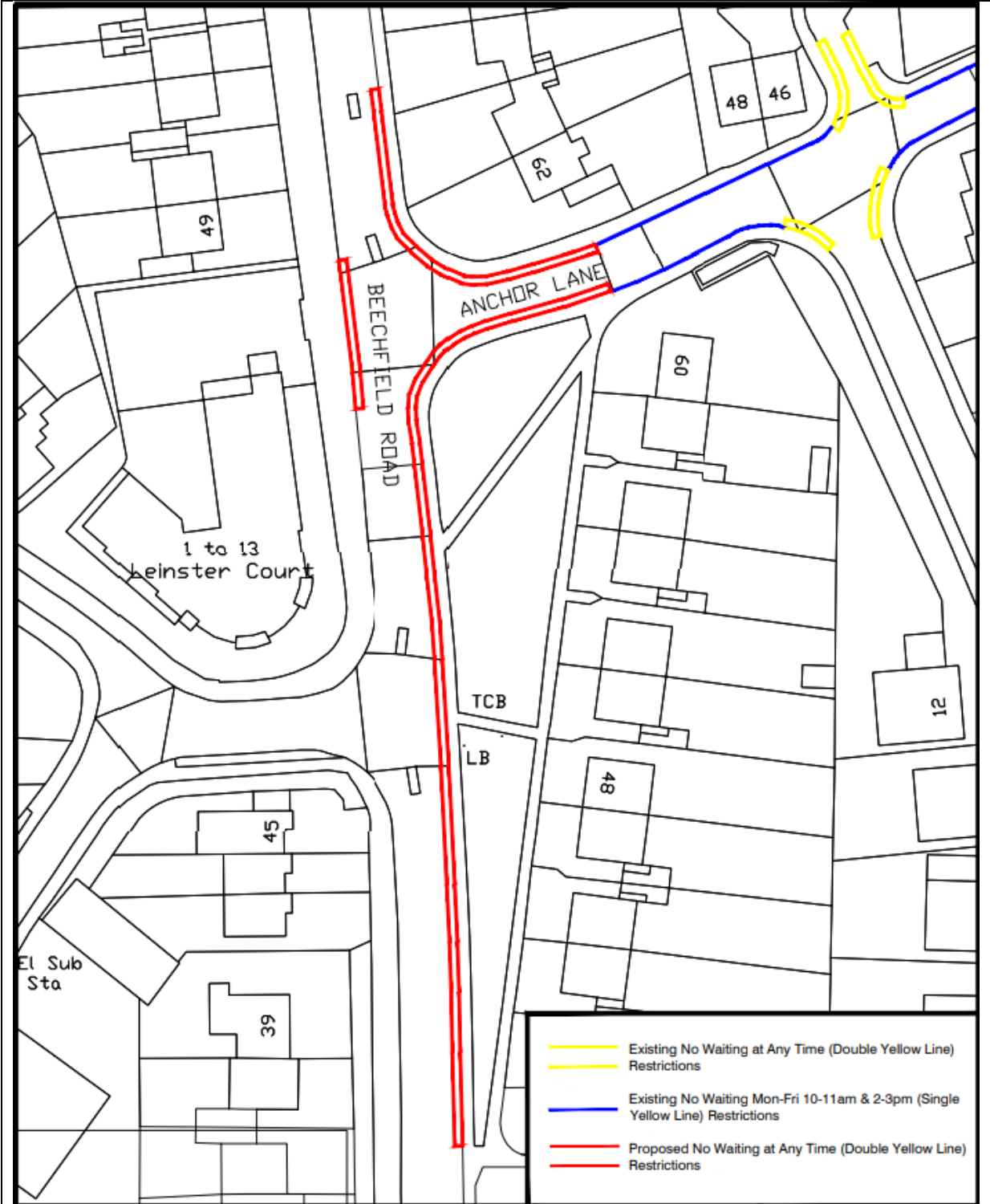

3. To delegate the decision to undertake a statutory consultation and implement the restriction, if applicable, to the Head of Commercial Development in consultation with the Portfolio Holder for Commercial Strategy & Delivery.

The reason for the decision is to deter inappropriate parking by parents at school drop off and pick up times and to prevent inappropriate and dangerous parking by residents parking on the grass verge adjacent to their residences on Beechfield Road

## EXECUTIVE DECISION RECORD SHEET

Having considered the duty imposed under section 122 of the Road Traffic Regulation Act 1984, It appears to the local authority that it is necessary and expedient to make an Order in the interests of:

- avoiding danger to persons or other traffic using the road or any other road or for preventing the likelihood of any such danger arising
- facilitating the passage on the road or any other road of any class of traffic (including pedestrians)

### **Reports considered: (here reference can be made to specific documents)**

No reports

### **Officers/Councillors/Ward Councillors/Stakeholders Consulted:**

Should the decision be approved consultations will take place with:

- The residents and/or organisations along the extent of the proposed restrictions
- Ward Councillors
- County Councillors
- Hertfordshire Constabulary Road Policing Strategy Unit
- Hertfordshire County Council Traffic Order Manager
- Hertfordshire County Council Highways Locality Officer
- Hertfordshire County Council Highways Strategy Manager (Dacorum)
- Hertfordshire County Council Passenger Transport Unit
- Hertfordshire Fire & Rescue Service
- East of England Ambulance Service

### **Monitoring Officer Comments:**

No comments to add to the report.

### **S151 Officer Comments:**

This project can be delivered within existing approved budgets.

### **Implications:**

Without appropriate measures, obstruction to pavements near South Hill School & Hemel Hempstead school will continue and inconsiderate parking on the junctions of Anchor Lane and on the grass verge on Beechfield Road will continue.

### **Risk:**

## EXECUTIVE DECISION RECORD SHEET

The intention of this consultation is to comply with legislation and therefore avoid the risk of non-compliance.

### **Value for Money:**

Based on previous projects, the costs of implementation are estimated to be approximately £10,183, consisting of the following estimated costs: £6,257 consultancy (including consultation, reports and Traffic Regulation Order), £1000 lining, £2000 advertising, and £926 any ancillary works/contingency (10%). The consultancy selected for this function have previously carried out consultations and design works for DBC and are familiar with the area. They are also one of the named contractors in the framework agreement for the provision of consultancy for traffic related operations and parking.

The cost will be taken from the Parking Services 'On-street consultancy budget' - MB200 3950.

There will be on-going revenue costs to maintain and enforce the yellow lines

### **Options Considered and reasons for rejection:**

Not to consult on the proposals, which would leave inappropriate parking issues unresolved.

### **Portfolio Holders Signature:**

**Date:**

### **Details of any interests declared and any dispensations given by the Standards Committee:**

### **For Member Support Officer use only**

Date Decision Record Sheet received from portfolio holder: 01 September 2022

Date Decision Published: 07 September 2022                      Decision No: PH-029-22

Date of Expiry of Call-In Period: 14 September 2022

Date any Call-In received or decision implemented:

### **BACKGROUND**

Councillor William Allen has been in contact with Parking Services following conversations with the police who are concerned about the inconsiderate parking on pavements on Anchor Lane, Hemel Hempstead from parents during school drop off and pick up times.

## **EXECUTIVE DECISION RECORD SHEET**

It is understood that there is currently confusion at the junction between Anchor Lane and Heath Road in relation to two different waiting restrictions directly next to one another for two differing time periods. This is leading to vehicles parking (and driving) on the pavements, leading to congestion and obstruction, and dangerous driving near schools.

Parking Services has discussed the area with Cllr Williams and it has been decided to introduce no waiting at any time (double yellow line) restrictions on Anchor Lane at the junction with Heath Lane up to the end of the current no waiting 'Monday-Friday 8.30am - 4.30pm' (single yellow line) restriction.

At the junction of Beechfield Road and Anchor Lane the request is to introduce additional no waiting at any time restrictions in order to prevent parking close to or on the mini roundabout, and to prevent the grass verge parking from happening from the junction to outside number 38 Beechfield Road. Currently residents are parking their vehicles on the grass verge preventing enforcement. We do not condone or recommend parking on grassed areas as it may be unsafe, it will more than likely damage a public amenity, it may involve driving over pavements (a police matter) as well as being unsightly and inconsiderate to users of the amenity.